

Prestige

Windows and Doors



ESWINDOWS

Prestige products meet today's top architectural trends:

- Narrow sightlines
- Superior energy efficiency
- Hurricane resistance
- Custom colors
- Insulating glass and thermally broken aluminum
- Corrosion-resistant hardware for coastal applications



Design. Quality. Luxury.

The Prestige residential line is designed for sophistication and style. Each piece is carefully manufactured and checked for quality, ensuring full functionality and the ultimate end-user experience. These luxury windows and doors are built to the highest specifications to meet our exceptional standards.

Prestige



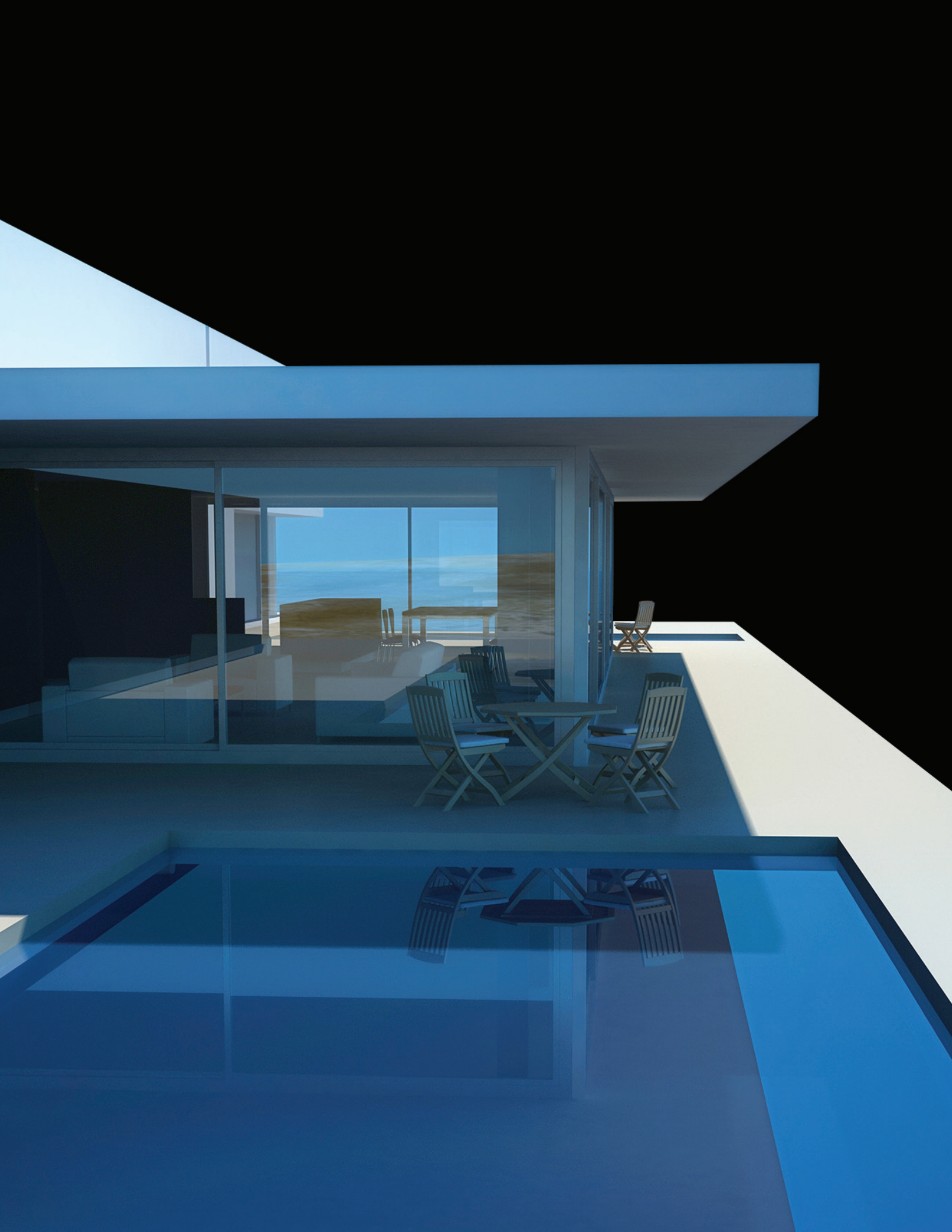

The Prestige collection was developed in collaboration with leading architects and designers who specialize in modern construction. The result: clean lines and large glass panels.

More than 30 years of experience as a window and door manufacturer has allowed us to develop this premier line of products that meet the highest performance standards. These products are crafted with one purpose: to bring the topmost quality and design to every project.

Prestige Features

Consolidated under a single source warranty
Available in two-tone finish
High performance insulation from efficient spacers
Superior energy performance with low U-values
Reduced sound transmission
Exclusive hardware
Extended warranty
Color or ultra-clear interlayers
Coastal hardware standard

Windows

ES-P252 Casement/Awning/Fixed Window
ES-FX2020 Fixed Window
ES-SW340 Sliding Window
ES-H340 Single Hung Window
ES-FX3050 Frameless Window
ES-8000T Jumbo Storefront Window

Doors

ES-46T Swing Door
ES-SGD2020 Sliding Glass Door
ES-SGD2040 ProSlide Door
ES-BF5010T Bifold Door

WINDOWS

ES-P252 Casement/Awning/Fixed Window

ES-P252 is an operable out-swing window that offers an unobstructed view and excellent ventilation. This product is ideal for areas that demand high light transmittance and minimal thermal transfer.

System Description

Casement

Small and large missile impact rated
Maximum size: 48" x 84"
Frame depth: 2 1/2"

Awning

Small and large missile impact rated
Maximum size: 42" x 37"
Frame depth: 2 1/2"

Fixed

Small and large missile impact rated
Maximum size: 60" x 144"
Frame depth: 2 1/2"

Features

Single arm operator and multi-point lock
High performance stainless steel four bar hinge or butt hinges
Head receptor, sub-sill and strap anchors available
Thermally broken frame
Flange or equal leg frame

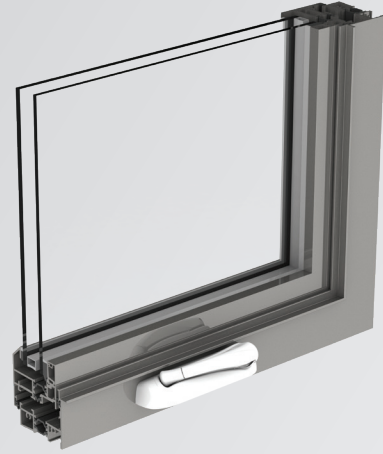

ES-FX2020 Fixed Window

The ES-FX2020 fixed window is a narrow window wall that allows homeowners to achieve a consistent look across the façade next to the ES-SGD2020.

System Description

Large missile impact rated

Maximum size: 60" x 144" panels or 72" x 120" panels

Frame depth: 6 7/16" (3 track), 8 1/2" (4 track)

Features

Fixed window designed to match ES-SGD2020 sliding glass door

Free standing jambs and self-mating mullions

Multiple panel configurations

Removable sill riser painted to match the door



WINDOWS

ES-SW340 Sliding Window

The ES-SW340 horizontal sliding window offers a wide window opening, while providing durability and maximum ventilation.

System Description

Small and large missile impact rated

Maximum size:

OX / XO: 83 15/16" x 63" equal, 92 11/16" x 63" unequal

XOX: 126" x 63"

Frame depth: 3 3/8"

Features

Polyamide rollers with stainless steel housing

Sweep lock

Thermally broken frame

Flange or equal leg frame



ES-H340 Single Hung Window

The ES-H340 is a single hung window that operates vertically and it is ideal for narrow spaces where accessibility and airflow are required.

System Description

Small and large missile impact rated

Maximum size:

O/X: 54" x 78" / 43" x 96" equal, 39" x 81" unequal

Frame depth: 3 3/8"

Features

Ultralift spiral balances

Snap and sweep lock

Thermally broken frame

Flange or equal leg frame



WINDOWS

ES-FX3050 Frameless Window

The ES-FX3050 frameless window is a glass wall that has no vertical aluminum profiles. The result is more glass and an unobstructed view.

System Description

Large missile impact rated

1 1/8" laminated glass

Maximum size: 60" x 144"

Frame depth: 3 3/8"

Shoe height: 4 3/4"

Features

Top and bottom rail options

Multiple module option available

Corner option available

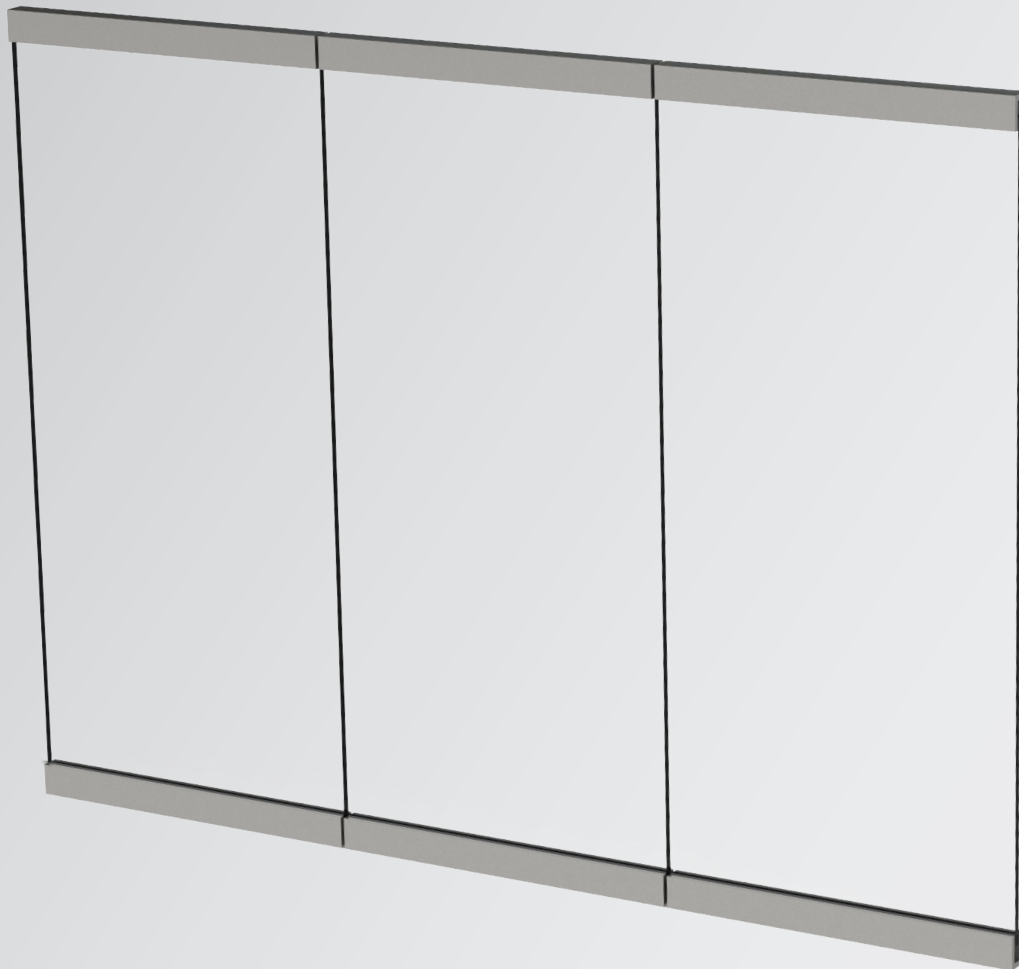
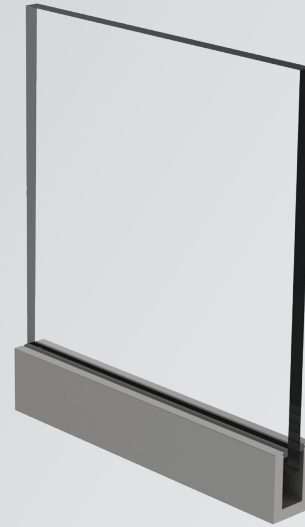

ES-8000T Jumbo Storefront Window

The ES-8000T Jumbo is an impact resistant, thermal storefront system. This product is isolated with pour and debridge for a superior thermal performance. The ES-8000T Jumbo storefront system is compatible with the ES-9000 impact door.

System Description

Large missile impact rated
Maximum size: 84" x 180" in a single frame
Frame depth: 5"

Features

Screw cover
Integral door adaptor
Pre-assembled and pre-glazed
Surface applied ogee or flat muntins
Thermally broken frame
Available with insulating glass

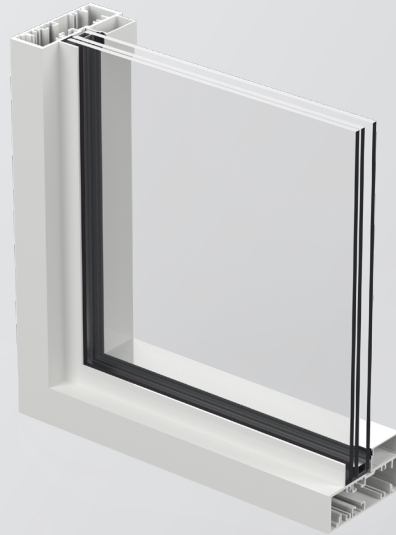

DOORS



ES-46T Swing Door

ES-46T is an out-swing door designed for balconies and open spaces. It pairs easy operation with a sophisticated modern look.

System Description

Small and large missile impact rated

Maximum size for single door: 41 3/16" x 108"

Maximum size for double door with side lites: 160" x 98"

Maximum size for double door: 80" x 120"

Maximum size for double door with transom: 80" x 132"

Frame depth: 4 1/2"

Standard threshold height: 2 1/4"

ADA threshold height: 1/2"

Features

ADA threshold and high bottom rail optional

Multi-point hardware

Thermally broken frame

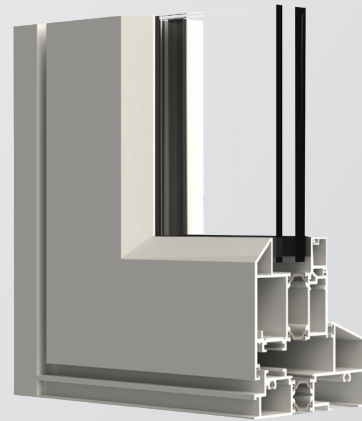

Sophistication and style

ES-46T Swing Door





Prestige

DOORS

ES-SGD2020 Sliding Glass Door

The ES-SGD2020 is an impact-rated sliding glass door with minimal sightlines. This narrow door features less aluminum and more glass than others allowing a clearer view.

System Description

Large missile impact rated

Maximum size: 72"x120" and 60"x144" available in 2,3,4 and 5 tracks

Frame depth: 4 3/8" (2 track), 6 7/16" (3 track), 8 1/2" (4 track), 10 9/16" (5 track)

Sill height: 1 7/8"

90 degree and 135 degree corners

2" interlocks

Features

Multiple panel configurations

Removable sill riser painted to match the door

Needle bearing acetal roller

Standard contemporary handle & thumb turn

2 point locking hardware

Multiple track options

Pocket configuration



ES-SGD2040 ProSlide Door

The ES-SGD2040 ProSlide sliding glass door uses exclusive hardware designed for maximum protection and ease of operation. Our low-rise threshold provides easy accessibility while meeting hurricane standards for water intrusion resistance.

System Description

Large missile impact rated
Maximum size: 72" x 120" panels
Frame depth: 6 1/2"
Configurations: OX, XO, OXO, XOX, OXXO
Sill height: 1 5/16"

Features

Exclusive wrap around hardware
Standard low sill option
Balances ADA accessibility and water intrusion protection
Effortless operation

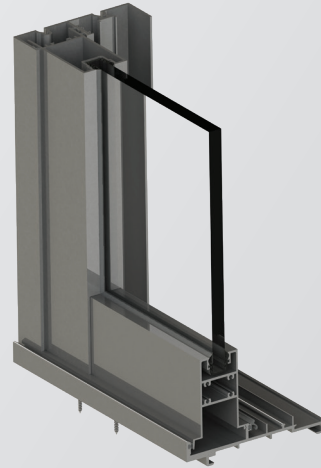

ES-BF5010T Bifold Door

The ES-BF5010T bifold door allows you to join two spaces effortlessly. The system provides a completely clear opening with a maximum of 120" in height.

System Description

Multiple 44" x 120" panels
Insulating laminated glass and laminated glass
2" threshold for maximum water infiltration protection
Maximum 16 panels center meet
Frame depth: 5"
Threshold height: 2 1/2"

Features

Thermally broken frames
ADA sill option



The perfect combination to expand
and connect spaces

Prestige

COLORS AND FINISHES

Standard Colors

Duranar



Sunstorm Silverstorm
UC106685F



Sunstorm Arcadia Silver
UC70123F

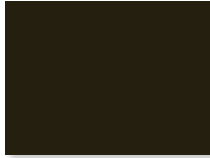

Bermuda Bronze
UC105262

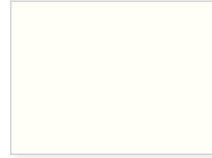

Bone White
UC43350



Black
UC40577

Woodgrain

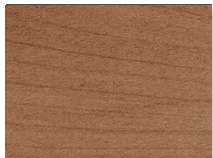

Embero
DS 739 2301/02L



Nogal
DS 750 1807/01L



Sapely
DS 750 2505/01L

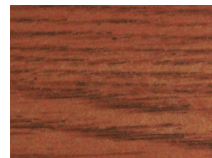

Teka
DS 733 2601/01L

Hardware Finishes



Silver



Antique Brass

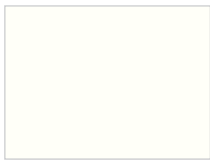

White



Black



Bronze



Brushed Chrome

*Hardware finishes available

**Class 1 clear anodized finish is available upon request

ACCESORIE

Design elements

The Prestige line pairs fine architectural details with uncompromising performance.

Every Prestige window and door is produced with the finest materials, using the latest technologies and benefiting from the skilled talent of our experienced team. The result is an aesthetic design with engineered precision and proven performance.



ES-P252



ES-46T



ES-SGD2020



ES-SGD2040



ES-BF5010T

EXPERTISE

Engineering and Design

We specialize in providing solutions for the most complex projects and responding efficiently to the requests of architects and developers. The combination of advanced software technology and a team of engineers and designers who specialize in aluminum, glass, window systems and façades, allows us to ensure delivery of high quality products that meet our customers' needs.

The Prestige line provides customers with the perfect combination of luxury, design and performance across a wide range of product types. Whether you are looking for noise reduction, temperature control, or protection from extreme weather, our line of products can provide the perfect solution, without sacrificing aesthetics.

Service

Our engineers and designers provide ongoing assistance and technical support to ensure the best solution for each type of project. We offer each customer complete and personalized guidance, pointing out the main factors to consider in order to plan and carry out their construction with maximum benefits.



Prestige

Design. Quality. Luxury.

ESWINDOWS
The Power of Quality

Prestige